

SURVEYOR'S RECORD

Section 30

Township 107

Range 111

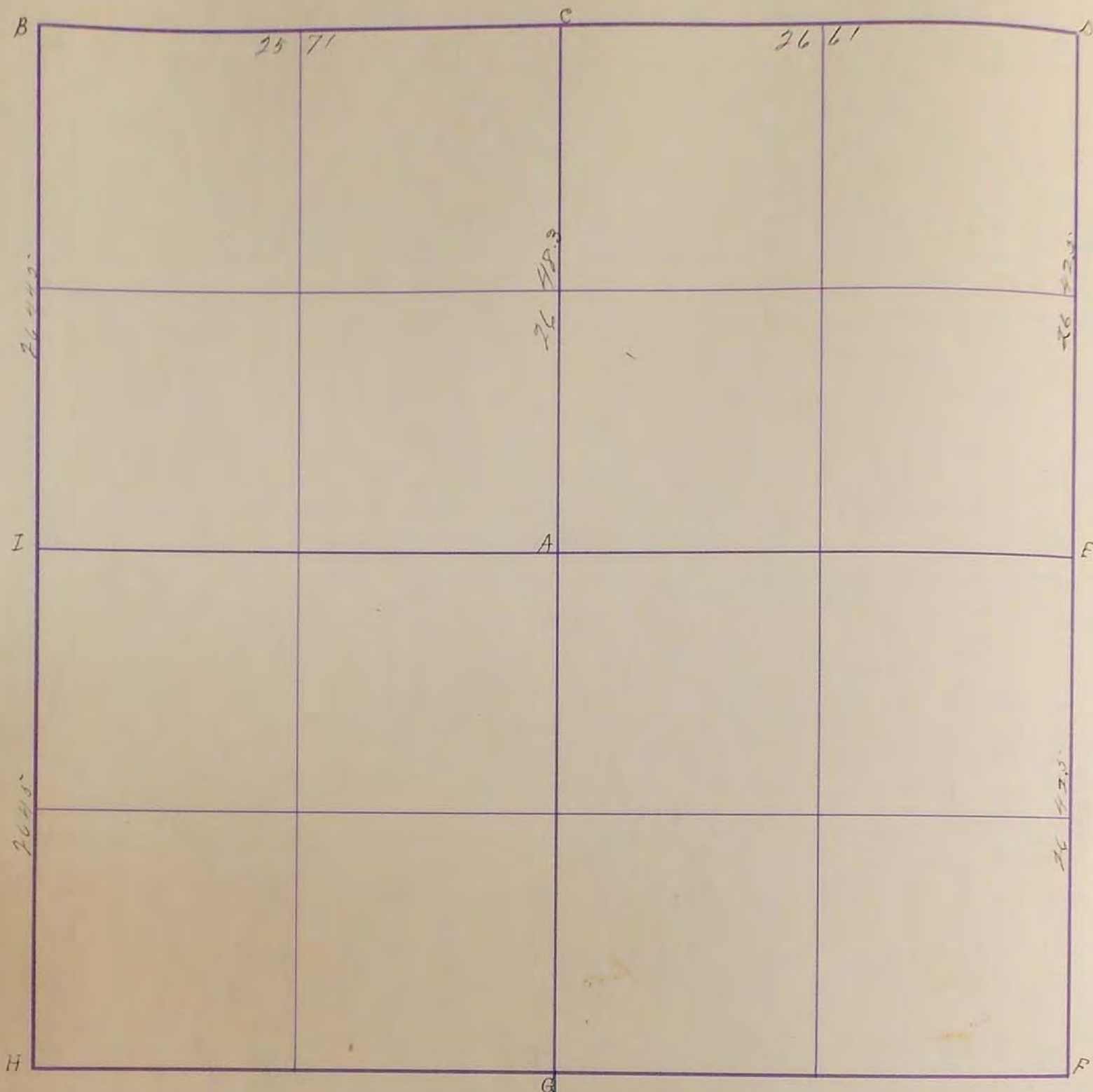

- A. Stone
- B. Stone +
- C. "
- D. Pipestone Rock 5X12X24 \square
- E. " " 5X20X30 \square
- F. " " 5X12X20 \square
- G. Cedar post 8" 4" high
- H. Stake mound + pit
- I. Stone

J. H. Hoolstencroft

Apr. 73 - 1901

- A.
- B. Boulder
- C.
- D. Pipestone Rock 5X12X24
- E. " " 5X20X30
- F. " " 5X12X20
- G. Cedar post 8" 4" high
- H. Stake mound + pit
- I. Stone " "

J. H. Hoolstencroft

June 20 - 1975

- B. Pink stone 6X8X18 "B" { Concrete Stone: R.P. Tack in cor. fence post NW 46° 3' R.P. Tack in cor. fence post NE 47° 5' (1940)
- C. Concrete Stone { R.P. Tack in cor. fence post South on line 348 R.P. Tack in light pole SE 79° 5' 1940

- D.
- E.
- F.
- G.
- H.

I found old corner Iron stake 10' E. of true line
 7 cor. 25.2' east.

1968

E. Iron Pin R.P. Nut on Apron
 NE - 44.05' SE - 48.50' SW - 48.95' N - 31.00'

D. Iron Pin R.P. Nut on Apron
 NW - 50.75' NE - 51.80' SW - 53.00' SE - 53.50'

Found Cedar post Placed Reanon
 Top: R.P. Tack in cor post North 828'
 R.P. Tack in blazed fence post NW
 P.A. March 1906

30
31

SURVEY No. 1112

Section 30 Town 107 Range 111

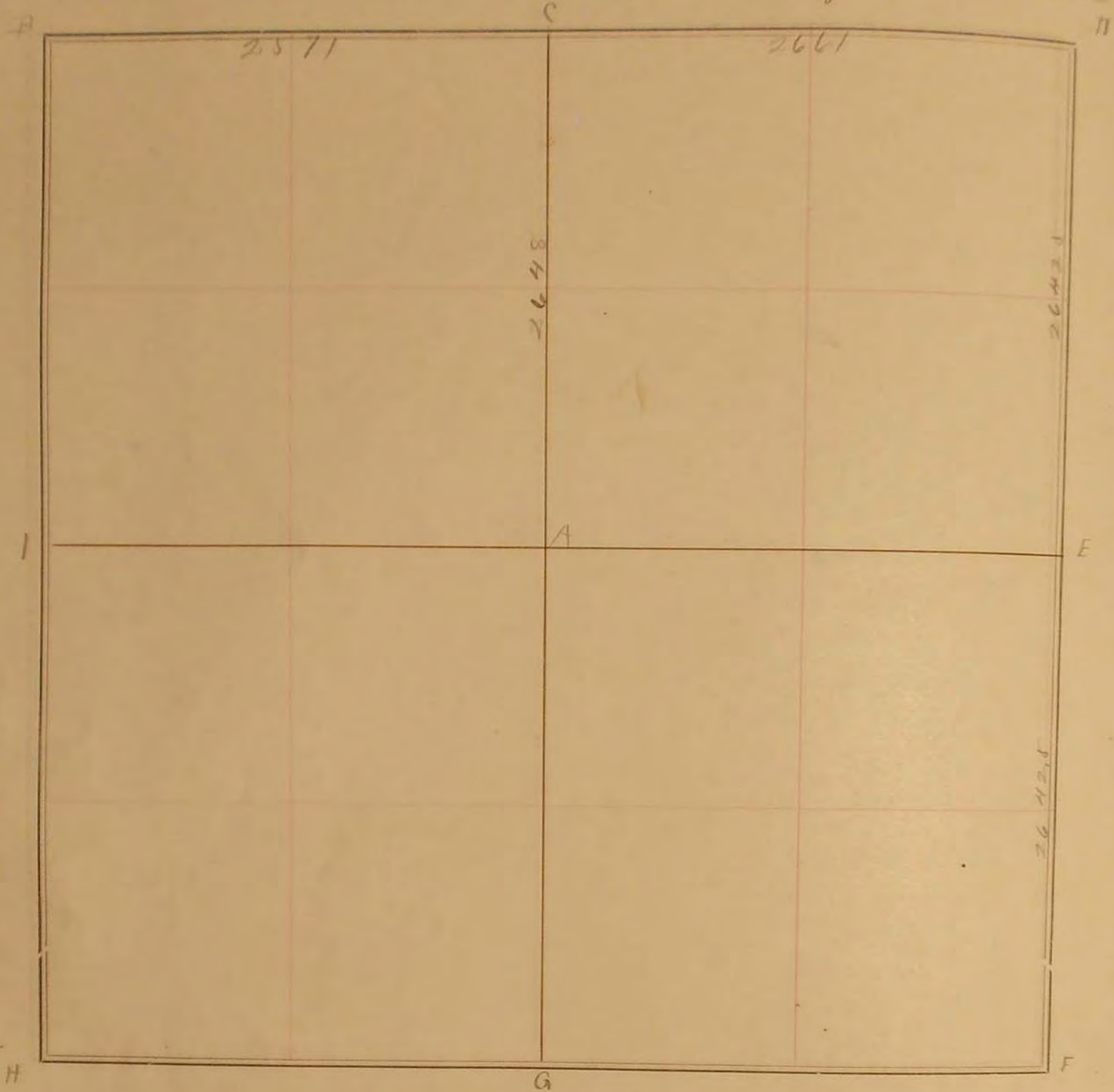

FIELD NOTES.

- A Stone
 - B " + X
 - C "
 - D Pipestone rock 5-12-24 Δ
 - E " " 5-20-30 B
 - F " " 5-12-20 Δ
 - G Cedar post 8" 4" high
 - H Stake mound and pit
 - I Stone
- see resolution of*

2 6260

6280

2630
43

SURVEY No. 1112

Section 30

Town 107

Range 41



FIELD NOTES.

April 23 1901

- A
- B Boulder
- C
- D pipestone rock 5x12x24
- E " " 5x20x30
- F " " 5x12x20
- G cedar post 8'-4' high
- H Stake, mounds + pits
- I stones, " " *J.W. Woodstetter*

SURVEY No. _____

Section 30 Town 107 Range 41

B

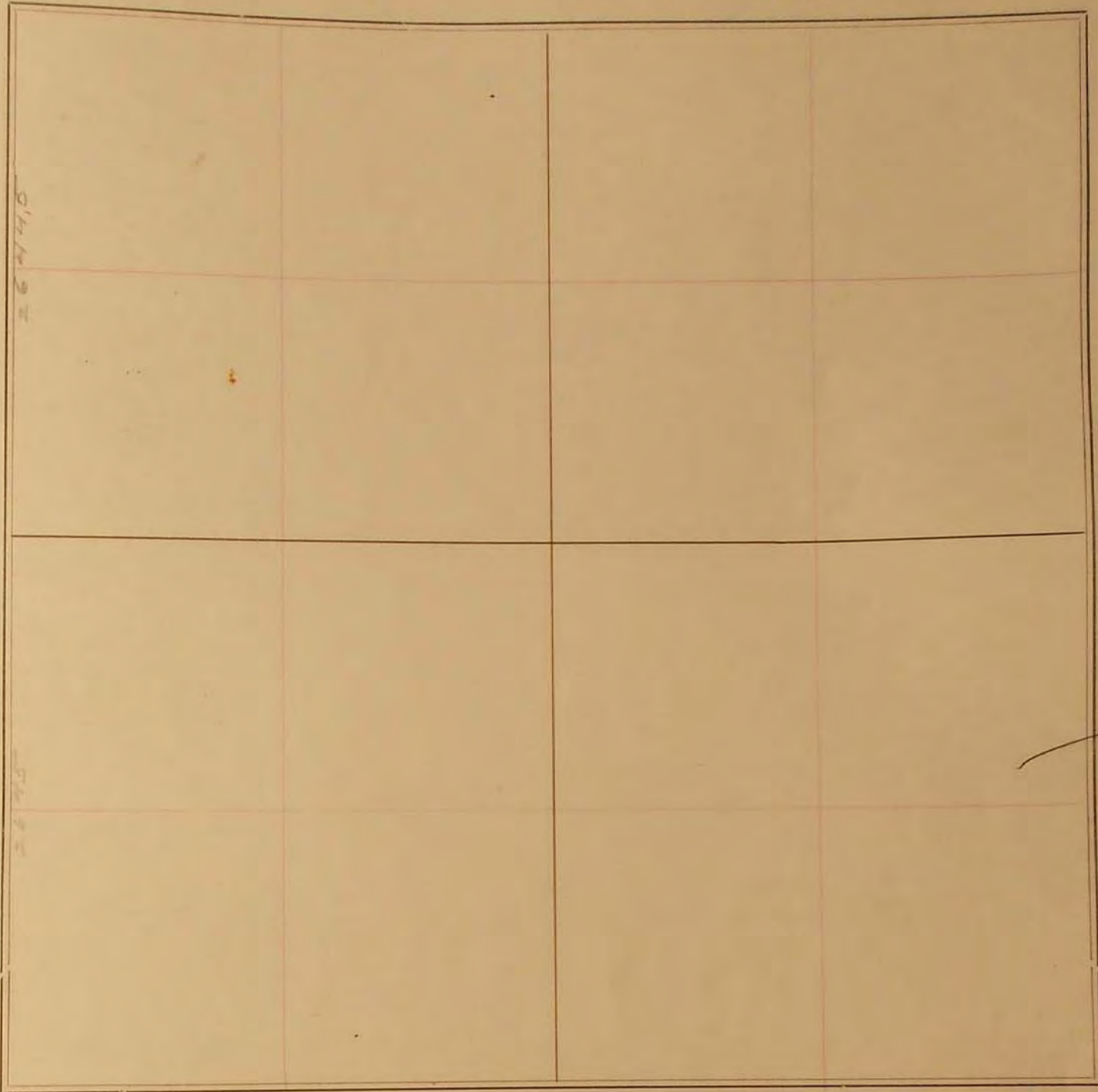

FIELD NOTES.

Jan 20 1925

Rich stone 6x8x18

E
F
G
H

Found old wire near stone 10' east of true line F or. 25.2 East